



**GASTROPARTS**

# Frima

**[EN]** Equipment

**[DE]** Geräte

**[ES]** Aparatos

**[FR]** Équipement

**[IT]** Attrezzature

**[PL]** Urządzenia

**[RU]** Оборудование

✉ [gastroparts@gastroparts.com](mailto:gastroparts@gastroparts.com)

☎ +48 56 657 00 66

📘 [fb.com/gastroparts.global](https://fb.com/gastroparts.global)

**GASTROPARTS.COM**





## heating elements

### heating elements for tilting bratt pan

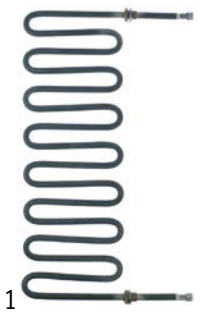
			
1			
<b>Part No.</b>	420211	<b>Ref. No.</b>	40.02.077
<b>description</b>	heating element 4000W 230V L 155mm W 440mm connection screw dry heating element heating circuits 1 tube ø 10mm 2 hole fixing thread 1/4" mounting distance 430mm		

## thermostats

### control and safety thermostats

#### EGO

#### safety thermostats

#### 55.32\_ series

			
1			
<b>Part No.</b>	375890	<b>Ref. No.</b>	4000638
<b>description</b>	safety thermostat switch-off temp. 650°C 3-pole starting temperature 624°C		

#### control thermostats with operation switch

#### 55.34\_ series



			
1			
<b>Part No.</b>	375570	<b>Ref. No.</b>	40.00.799
<b>description</b>	thermostat t.max. 470°C temperature range 100-470°C 1-pole 1NO 16A probe ø 3.9mm probe L 228mm capillary pipe 1110mm capillary pipe isolated 600mm gland nut shaft ø 6x4.6mm shaft L 24mm shaft position upper rotation 270° outer switch 2NO		

## lamps

### indicator lights

<b>lamps</b>			
<b>neon light bulbs</b>			
			
1			
<b>Part No.</b>	359585	<b>Ref. No.</b>	30240300
<b>description</b>	neon light bulb socket E10 230V green ø 10mm L 28mm		
<b>accessories for</b>	359585		
	<b>Part No.</b>	359060	<b>Ref. No.</b> —
	lamp socket mounting measurements ø16.2mm socket E10 connection screw		
	<b>Part No.</b>	359685	<b>Ref. No.</b> —
	lamp socket mounting measurements ø16.2mm socket E10		

### screw-on/push-on fit

<b>neon light bulbs</b>			
			
1			
<b>Part No.</b>	359585	<b>Ref. No.</b>	30240300
<b>description</b>	neon light bulb socket E10 230V green ø 10mm L 28mm		
<b>accessories for</b>	359585		
	<b>Part No.</b>	359060	<b>Ref. No.</b> —
	lamp socket mounting measurements ø16.2mm socket E10 connection screw		
	<b>Part No.</b>	359685	<b>Ref. No.</b> —
	lamp socket mounting measurements ø16.2mm socket E10		

### oven lamps

<b>universal oven lamps</b>			
<b>mounting diameter 35.5mm</b>			
			
1			
<b>Part No.</b>	359723	<b>Ref. No.</b>	3025.0002 3025.0004
<b>description</b>	oven lamp glass thr.ø 33.5mm ø 51mm borosilicate glass temp.-resist. 550°C		
<b>accessories for</b>	359723		
	<b>Part No.</b>	359721	<b>Ref. No.</b> —
	gasket silicone ED ø 48mm ID ø 39.5mm thickness 5mm Qty 1 pcs		



## electronic controllers

### ELIWELL

#### universal controllers

##### built-in version



1	<b>Part No.</b>	378303	<b>Ref. No.</b>	40.01.360
	<b>description</b>	electronic controller ELIWELL type IDPlus 902 mounting measurements 71x29mm 230V voltage AC NTC/Pt1000/PTC relay outputs 8A -55 up to +150°C display 3 digits + algebraic sign		
	<b>accessories for</b>	378303		
	<b>Part No.</b>	379052	<b>Ref. No.</b>	—
	<b>description</b>	temperature probe PTC 1kOhm cable silicone probe -50 up to +150°C cable -50 up to +180°C probe ø6x40mm cable length 1.5m without screw connection 2-wire		
	<b>Part No.</b>	379053	<b>Ref. No.</b>	—
	<b>description</b>	temperature probe PTC 1kOhm cable PVC probe -50 up to +150°C cable -10 up to 100°C probe ø6x30mm cable length 3m without screw connection 2-wire		
	<b>Part No.</b>	379064	<b>Ref. No.</b>	—
	<b>description</b>	temperature probe PTC 1kOhm cable silicone probe -50 up to +150°C cable -50 up to +180°C probe ø6x40mm cable length 3m without screw connection 2-wire		
	<b>Part No.</b>	379142	<b>Ref. No.</b>	—
	<b>description</b>	temperature probe PTC 1kOhm cable PVC probe -50 up to +150°C cable -10 up to 100°C probe ø6x30mm cable length 1.5m without screw connection 2-wire		
	<b>Part No.</b>	379160	<b>Ref. No.</b>	—
	<b>description</b>	temperature probe NTC 10kOhm cable thermoplastic probe -40 up to +110°C cable -40 up to +110°C probe ø6x14mm cable length 1.5m without screw connection 2-wire		
	<b>Part No.</b>	379161	<b>Ref. No.</b>	—
	<b>description</b>	temperature probe NTC 10kOhm cable thermoplastic probe -40 up to +110°C cable -40 up to +110°C probe ø6x14mm cable length 3m without screw connection 2-wire		
	<b>Part No.</b>	379162	<b>Ref. No.</b>	—
	<b>description</b>	temperature probe NTC 10kOhm cable thermoplastic probe -40 up to +110°C cable -40 up to +110°C probe ø6x14mm cable length 6m 2-wire		
	<b>Part No.</b>	379169	<b>Ref. No.</b>	—
	<b>description</b>	temperature probe NTC 10kOhm cable thermoplastic probe -40 up to +110°C cable -40 up to +110°C probe ø6x14mm cable length 2m without screw connection 2-wire		
	<b>Part No.</b>	379199	<b>Ref. No.</b>	—
	<b>description</b>	temperature probe PTC 1kOhm cable PVC probe -50 up to +150°C cable -10 up to 100°C probe ø6x30mm cable length 5m without screw connection 2-wire		
	<b>Part No.</b>	379343	<b>Ref. No.</b>	—
	<b>description</b>	temperature probe NTC 10kOhm cable silicone probe -40 up to +110°C cable -50 up to +180°C probe ø6x40mm cable length 3m 2-wire		
	<b>Part No.</b>	379458	<b>Ref. No.</b>	—
	<b>description</b>	temperature probe NTC 10kOhm cable silicone probe -40 up to +110°C cable -50 up to +180°C probe ø6x40mm cable length 1.5m without screw connection 2-wire		
	<b>Part No.</b>	379630	<b>Ref. No.</b>	—
	<b>description</b>	temperature probe NTC 10kOhm cable thermoplastic probe -40 up to +110°C cable -40 up to +110°C probe ø6x14mm cable length 2.5m without screw connection 2-wire resistor 10kOhm		

## probes

### producer-specific probes

#### core probes



1	<b>Part No.</b>	378646	<b>Ref. No.</b>	24.01.122 24.01.300 24.02.645 87.00.301 87.00.527 87.00.559
	<b>description</b>	core temperature probe cable PTFE connection coded plug probe ø3x100mm cable length 2.7m handle ø 12mm handle length 44mm		



1	<b>Part No.</b>	378279	<b>Ref. No.</b>	40.02.045
	<b>description</b>	core temperature probe thermocouple K (NiCr-Ni) cable PTFE probe -40 up to +250°C cable -40 up to +250°C connection 2-wire probe ø3.5x100mm cable length 2.6m handle ø 10mm handle length 40mm		

## flow meters and flow sensors

### flow sensors



1	<b>Part No.</b>	402256	<b>Ref. No.</b>	4001311
	<b>description</b>	flow sensor inlet ø 10mm outlet ø 10mm L 110mm flow rate 1-25l/min		

## fans

### hot air motors

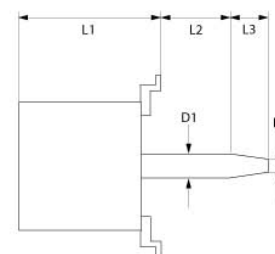

1	<b>Part No.</b>	500169	<b>Ref. No.</b>	3100.1023
	<b>description</b>	fan motor 220-240/380-415V 3 phase 50Hz 1kW 1400rpm speeds 1 L1 190mm L2 41mm L3 37mm M10R IT 4.0/2.3A power input 1250W at 50Hz 1400rpm type L9FGw4D-395 no. X1 D1 ø 17mm D2 ø 13mm		



## motors

### gear motors

for ovens

for flues



1

<b>Part No.</b>	361999	<b>Ref. No.</b>	3101.1010 3101.1010S
<b>description</b>	gear motor CROUZET type 82841042 12V voltage DC shaft $\varnothing$ 4mm L 65mm W 50mm H 51mm for oven		

## gas burners

### bar burners



1

<b>Part No.</b>	109184	<b>Ref. No.</b>	72.00.048
<b>description</b>	insulation for burner $\varnothing$ 97.5mm ID $\varnothing$ 62.5mm thickness 9.5mm		

## equipment-specific units

### for tilting bratt pans

motors



1

<b>Part No.</b>	417769	<b>Ref. No.</b>	4001602
<b>description</b>	lifting cylinder		

## gaskets

### special gaskets

for combi-steamers



1

<b>Part No.</b>	699803	<b>Ref. No.</b>	72.00.020
<b>description</b>	gasket L 139mm W 130mm silicone thickness 4mm		

## hose reels and spray guns

### spray guns



1

<b>Part No.</b>	542380	<b>Ref. No.</b>	50.00.549 50.00.549S 5000590
<b>description</b>	spray gun removable L 165mm		

### hose reels

#### appliance hose reels



1

<b>Part No.</b>	542381	<b>Ref. No.</b>	50.00.799 50.00.799P
<b>description</b>	hose reel without spray gun hose length 1m		



## ancillary products

### clamps

#### double wire clamps



1

<b>Part No.</b>	505351	<b>Ref. No.</b>	2066.0527V
<b>description</b>	wire clamp ø 11.6-12.2mm wire gauge ø 1.5mm zinc-coated steel Qty 100 pcs		

## fastening material

### fasteners

#### clamps

#### double wire clamps

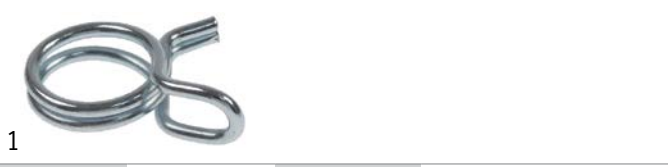

1

<b>Part No.</b>	505351	<b>Ref. No.</b>	2066.0527V
<b>description</b>	wire clamp ø 11.6-12.2mm wire gauge ø 1.5mm zinc-coated steel Qty 100 pcs		

## consumables

### sealants and adhesives

#### high temperature silicone



1

<b>Part No.</b>	890107	<b>Ref. No.</b>	50060200 50060207
<b>description</b>	high temperature silicone TOMABOND TB76 -40 up to +250°C red/brown tube 90ml		
<b>description</b>	Tomabond TB76 - tube 90ml - red brown Special elastic silicone for general bonding & sealing applications with high thermal loads. TB 76 is primarily used in building services, HVAC and mechanical engineering. Temperature-resistant to 300 °C over the short term		

**GASTRO**PARTS.COM

